

**Business Anywhere.**



### **CENTURY III**

The Century III was designed around bigger gatherings. With a 500 gallon holding tank, it can accommodate up to 1500 flushes. It features the same easy to clean interior, easy maintenance, and set up exterior of the Century II in a larger event handling frame.

# Century III Bathroom Trailer



1. Century III Standard Men's Cubicle



2. Utility Access



3. Century III Standard Women's Cubicle

## A. Century III Standard Features

- Lockable base cabinets
- Solid surface countertop with stainless steel sink
- Self closing faucets
- Soap dispenser
- Shatter proof mirror
- Ceramic china, pedal flush toilets
- Auto flush, ceramic china urinal (men's restroom only)
- Toilet paper holder
- Sanitary supply receptacle (women's restrooms only)
- Paper towel dispenser
- Waste basket cut out and waste basket
- Smooth durable white fiberglass interior
- 1 Piece non skid rubber flooring
- 1 Piece ceiling with built in air supply and air return
- Automatic door closers
- Occupancy lighting
- 1 Piece aluminum roof
- Screwless exterior perfect for your business' graphics
- Porch lights at all entry doors
- Fold down aluminum step platforms with railings
- 3" quick connect waste tank access valve
- 1" wash out plug
- Fresh water hook up
- 15 Amp receptacle
- Roof mounted air conditioner
- Insulated walls and ceiling
- 3 Year frame and structural warranty

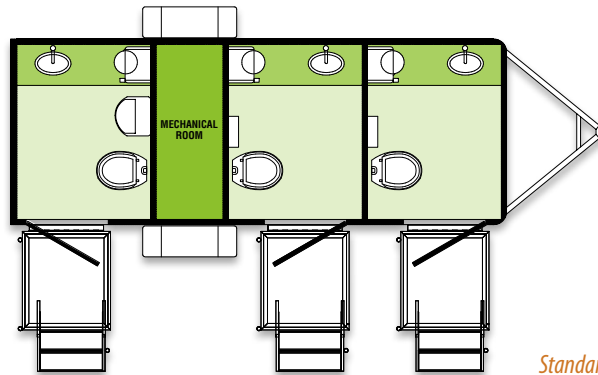

Standard Floorplan

## B. SHOWER COMBO OPTION

The shower combo option is available on any Century II, III, and V. If you want 1, 2, or all the cubicles to have shower combos, we can accommodate.

### Shower Combo Features

- 32 X 32 Shower pan
- Self closing faucets
- Shampoo and soap dispensers
- Pre-formed corner sink
- Double toilet paper holder
- Shatter proof mirror
- Ceramic china, pedal flush toilets
- Paper towel dispensers
- Waste basket
- Smooth durable white fiberglass walls
- 1 Piece non-skid rubber flooring
- 1 Piece ceiling with built-in air supply and air return

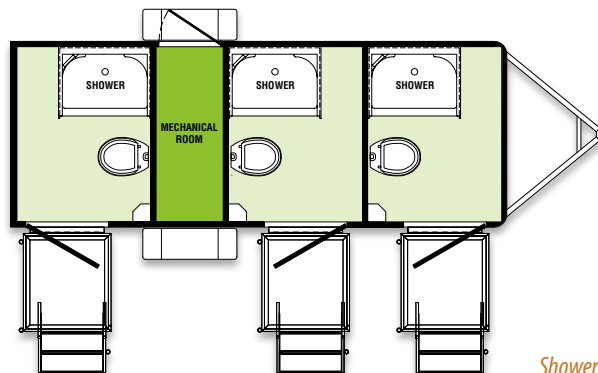

Shower Combo Option



[www.forestriverinc.com](http://www.forestriverinc.com)

A Berkshire-Hathaway Company

"All illustrations and specifications contained in this literature are based on the latest product information at time of publication. Forest River reserves the right to make changes in prices, colors, materials, equipment and specifications at anytime, without notice, and assumes no responsibility for any error in this literature. All units are shipped F.O.B. point of manufacture."

### WARRANTY INFORMATION

Every trailer is covered by a (three) year limited warranty. The terms or conditions of this warranty will be included with each trailer's certificate of origin. You will receive these documents when a trailer is paid in full. The warranty period will begin on the date of retail sale. Please fill out the registration card when you purchase the trailer and return it to Forest River, Inc.

<b>Forest River Cargo</b> 3731 California Rd. Elkhart, IN 46514 P: 574.266.7515 F: 574.266.7532	<b>Forest River Cargo</b> 193 Industrial Dr. Ocilla, GA 31774 P: 229.468.3352 F: 229.468.3138	<b>Forest River Cargo</b> 1430 SE Uglow Dallas, OR 97338 P: 503.831.5435 F: 503.831.5981	<b>Forest River Cargo</b> 8300 Imperial Dr. Waco, TX 76712 P: 254.420.0171 F: 254.420.1268
---	---	--	--

F-66-137

2008 Forest River, Inc.

Litho U.S.A.

Your Century Dealer: